

# PAREX

## Render Systems and Façade Solutions



**Creating colour and finish by design**

# MONOBLANCO, MONOREX GM & MONOREX GF

THROUGH COLOURED WEATHER RESISTANT DECORATIVE ONE-COAT RENDERS AVAILABLE IN A RANGE OF COLOURS IN TWO DIFFERENT FINISHING GRADES WITH MONOBLANCO AS A BRIGHT WHITE OPTION



BL10 Monoblanco & Blanc Du Littoral



G00 Natural White



G20 Off-White



J20 Pale Yellow

## DESCRIPTION

Through coloured one-coat weather resistant and breathable decorating render for vertical masonry and concrete walls. 48 Standard colours available, with Monoblanco as a separate bright white version. Non standard colours are available subject to colour approval.

## SUITABLE SUBSTRATES

Masonry and walls conforming to BS 5628-3 and constructed from the following:

- Concrete blocks.
- Bricks\*.
- Terracotta blocks e.g. Porotherm\*.
- Lightweight aircrete concrete blockwork e.g. Celcon.
- Breeze blocks (clinker).
- Stone/rubble stone.
- Shuttered concrete\*.
- Expanded clay insulation blocks\*.
- Clean, sound, well adhered existing render.
- Base coats conforming to BS EN 13914-1
- PAREX grey weather resistant base coats, e.g. MONOGRIS E, PARMUREX or TRADIREX.
- Dry-stacked inter-locking modular wall units e.g. Durisol\*\*

For below DPC applications and old substrates in accordance with BS8000 - 4 Code of Practice for Waterproofing, consult Parex.

\*Consult masonry manufacturer's datasheets. Durisol with Monorex GM & GF is NHBC approved for single skin external wall construction.

\*Apply MICRO GOBETIS 3000 to low porosity or high absorption substrates.

## UNSUITABLE SUBSTRATES

- Weak mortar or plaster (Gypsum) coated constructions.
- Painted substrates - use PARINTER first.
- Avoid applications onto horizontal flat substrates or those with a backward incline as this may affect water run off and may have a tendency to hold moisture.

## FINISHES

- Medium Scraped - Monoblanco/Monorex GM
- Fine Scraped - Monorex GF
- Trowel/float smoothed
- Spray Textured - from tyrolean to heavy roughcast effects  
(Please note: A heavy roughcast may use a large quantity of product).
- For enhanced performance apply PARAGUARD

\*The trowel/float smoothed finish may vary in appearance, particularly due to different factors such as the line and level and condition of the substrate or the appearance of a slurry finish caused by over floating the surface. The latter may produce some micro cracking effect on the render surface which may affect the aesthetical appearance but does not affect its durability. For full technical information please consult the Parex product data sheet for Monoblanco, MonorexGM/Monorex GF. If you would like a project specific specification, please contact Parex.

- The colour BL10 is product specific to MONOBLANCO and BLANC DU LITTORAL. Parex offers a comprehensive range of 48 standard and specialist bespoke colours for MONOREX GM and MONOREX GF.
- The colours in the range may be available on a range of other Parex renders. Prior to commencement on site, it is recommended that a test panel is produced for inspection to qualify the finish, texture, colour and appearance of the render.
- The colours shown are indicative only and should only be used as a reference guide.
- Parex can provide colour samples for planning applications or for design consideration. These are generally available in a scraped finish. Other finishes can be provided to order.

# 751 LANKOLATEX

ADMIXTURE FOR KEY COAT PREPARATION TO ONE COAT RENDERS, BONDING AND WATERPROOFING FOR ALL RENDERS



## DESCRIPTION

A white liquid admixture used for a range of key coat preparations, as a bonding agent and for waterproofing purposes. 751 LANKOLATEX is designed as an additive to enhance a range of mortars to provide increased adhesion or bonding capabilities to a range of substrates or can be used as an additive to create a slurry bonding coat which can be brush or trowel applied.

## FIELDS OF APPLICATION

- Key coat for hydraulic, mineral render coatings and screeds and low absorption substrates.
- Assists with bonding applications for cement based coatings.
- To control suction on high absorption substrates such as lightweight aircrete blocks.
- Waterproof coatings for tanking, reservoirs, holding tanks and swimming pools.
- Bonding and waterproofing of plaster coatings.
- Apply to existing cement screeds as a slurry coat without the need for special surface preparations.
- Enhances screed for laying tiles.
- Use as a bonding agent when coating, re-profiling or reshaping mortar for patching areas such as damaged corners of concrete.
- Bonding mortar for repairing concrete (bridging mortar for construction joints).
- Enhancing mortars for fixing/bonding prefabricated elements.
- Pointing and filling mortar for voided masonry joints, chimney stacks, or to form a mortar flashing.
- Repair of concrete floors.

# PAREX TV10 REINFORCING MESH

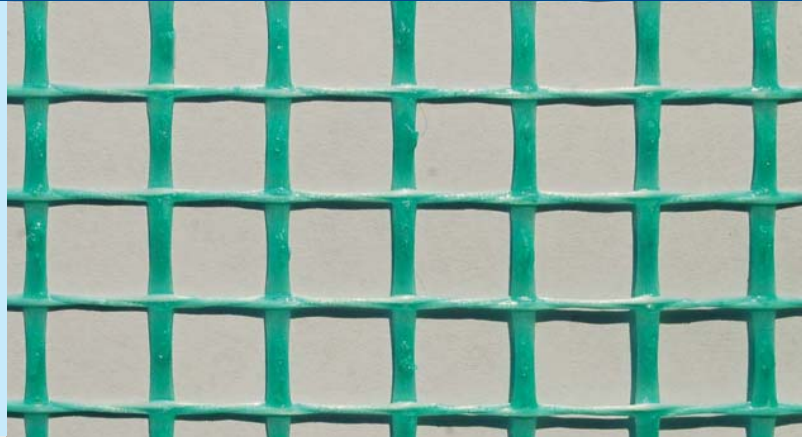

## DESCRIPTION

A glass fibre mesh fabric combined with specially designed surface treatments that can be used in a wide range of Parex cement and lime render applications. For ease of identification the Parex TV10 mesh is coloured green and has the Parex logo throughout the mesh.

## PROPERTIES

- High mechanical strength.
- Excellent dimensional stability.
- Due to its large mesh size, TV10 is a reliable reinforcement for external facade renders.

## APPLICATION

TV10 mesh can be used in the application of all Parex mineral render finishes e.g. MONOREX GM & GF, MONOBLANCO, BLANC DU LITTORAL, PARMUREX.

Use across all vulnerable locations e.g. around openings, and across different substrates or for complete use across the whole substrate. Overlap the mesh a minimum of 100mm.

## TYPICAL MESH REINFORCEMENT DETAILS

B1

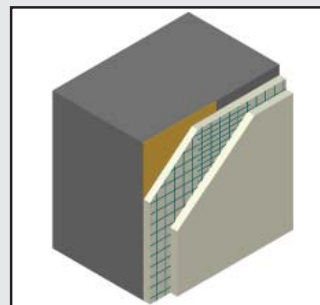

B2

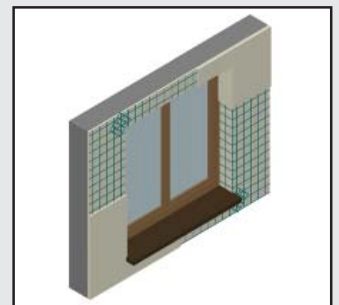

For full size details and other application details please contact Parex.

# MICRO GOBETIS 3000

BONDING COAT FOR LOW POROSITY/HIGH ABSORPTION/SMOOTH SURFACES E.G. CONCRETE AND LIGHTWEIGHT BLOCKWORK



## DESCRIPTION

- A coloured liquid for ease of application recognition.
- MICRO GOBETIS 3000 improves the adhesion for one coat render systems e.g. MONOREX GM & GF, MONOBLANCO, BLANC DU LITTORAL or for the PAREX THERM and PAREX DIRECT render systems, when applied to low porosity or high absorption substrates.
- Using it will minimise the risk of air pockets occurring in the application of one coat render systems.

## SUITABLE SUBSTRATES

- Smooth, low porosity substrates such as cast in-situ concrete, formed concrete lintels and panels or engineering bricks.
- High absorption substrates such as lightweight aircrete blockwork, common bricks and certain float smoothed, well adhered, render surfaces.

## APPLICATION

- For low porosity substrates, apply in a single coat using a roller or brush.
- On high absorption substrates e.g. lightweight aircrete blockwork, the application may require two coats. For two coat applications, apply a diluted (maximum 5% with clean water) first coat of MICRO GOBETIS 3000, allow to dry then apply an undiluted second coat. Test the substrate for suction i.e. using a plasterers paddle brush, cast some water at the treated surface and if it sucks in, apply a further coat, if it sits on the surface the substrate is ready for the render application.
- To avoid excessive applications, it is recommended this procedure is completed after the first coat, as subsequent coats may not be required. Once suction control is satisfactory continue with the render application.
- The render product or system can be applied as soon as the MICRO GOBETIS 3000 is dry, i.e. after 1 to 24 hours depending on weather conditions.
- Fully mix the product before use to maintain an even consistency.

For full technical information please consult the Parex product data sheet for Micro Gobetis 3000. If you would like a project specific specification, please contact Parex.

# PARAGUARD

LOTUS LEAF EFFECT WATER & STAIN REPELLENT



## DESCRIPTION

PARAGUARD is a water based coating, which provides a weatherproof, lotus leaf effect, water resistant surface to a range of render, masonry and timber substrates. PARAGUARD is safe to the environment and to those using it. The product may be applied by brush, lambswool roller or airless spray gun to achieve a non-staining, clear, natural coating which is easily cleaned. PARAGUARD is pre-packaged and ready for on-site use. The product is non-sacrificial, so once cleaned, will not need to be re-coated.

PARAGUARD finish is specially formulated with exceptional hydrophobic properties. Buildings coated with PARAGUARD finish are cleaned time and time again with natural rain water. As water hits the surface, it simply beads off the exterior and helps to remove dirt and grime from the surface. PARAGUARD is also recommended for highly exposed or coastal locations to provide an enhanced weathering coat.

## BENEFITS

- Protects facades with non-film forming coating.
- Does not alter surface appearance.
- Excellent penetration.
- Permanent protection.
- Water-based with zero VOC's.
- May assist against mould and mildew.
- Can be used on damp substrates.
- UV and weather resistant.

For full technical information please consult the Parex product data sheet for Paraguard. If you would like a project specific specification, please contact Parex.

# PARMUREX

ONE COAT WEATHER RESISTANT GREY  
RENDER (CAN BE USED AS A FINISHING COAT)



## DESCRIPTION

One-coat weather resistant grey render for internal and external walls. Suitable as a grey coat finishing render or as a base coat for receiving a Parex decorative finish. e.g. 311 COATING, DPR TEXTURED FINISHES, 630 CERASTONE, 632 SPRAYSTONE, AMS systems.

## SUITABLE SUBSTRATES

Masonry and walls conforming to BS 5628-3 and constructed from the following:

- Concrete blocks.
- Bricks\*.
- Shuttered concrete\*.
- PAREX grey weather weather resistant base coats, e.g. TRADIREX
- For below DPC applications and old substrates in accordance with BS8000 - 4 Code of Practice for Waterproofing, consult Parex.

\* Apply a sealer/bonding coat of MICRO GOBETIS 3000 before applying the PARMUREX.

For wet substrates mix 751 LANKOLATEX with the PARMUREX to assist against lime blooming.

## UNSUITABLE SUBSTRATES

- Lightweight aggregate, aircrete concrete or terracotta blockwork.
- Weak mortar or plaster (Gypsum) coated constructions.
- Avoid applications onto horizontal flat substrates or those with a backward incline as this may affect water run off and may have a tendency to hold moisture.

## FINISHES

- Fine Scraped
- Sponge or Trowel Smoothed\*
- Spray Textured - from tyrolean style to heavy roughcast effect.

(Please note: A heavy roughcast may use a large quantity of product).

- For enhanced performance apply PARAGUARD

\*The trowel/float smoothed finish may vary in appearance, particularly due to different factors such as the line and level and condition of the substrate or the appearance of a slurry finish caused by over floating the surface. The latter may produce some micro cracking effect on the render surface which may affect the aesthetical appearance but does not affect its durability.

# PARINTER RENOVATION

PREPARATORY BONDING COAT FOR RENDERING  
ONTO EXISTING PAINTED MASONRY OR RENDER



## DESCRIPTION

A restoration and bonding mortar for the renovation of old hydraulic cement or lime based renders, sound or cracked but not delaminated, including render or masonry that has been painted or has received a thick textured coating system. Only the addition of clean water on site is required. Designed to create a new base coat render suitable for taking a range of decorative finishes including: Decorative coatings, decorative top coat renders and finishes.

\* Ensure you follow the Preliminary Identification Test guidelines on the PARINTER data sheet.

## PROPERTIES

Its composition and adhesion properties make it compatible with a large number of non porous or smooth substrates (painted surfaces, hydraulic renders or concrete). Suitable Parex finishes that can be applied onto PARINTER:

- Decorative coatings: CALCILANE BADIGEON, CALCILANE ANTICO
- Decorative finishes: CALCIDECO, CALCILANE ENDUIT.
- Decorative renders: MONOBLANCO, MONOREX GM, MONOREX GF, PAREXAL, PARLUMIERE CLAIR, PARLUMIERE FIN or PARLUMIERE MOYEN.

## SUITABLE SUBSTRATES

Sound rendered masonry including those with a thin paint coating <300 μ (pliolite, acrylic based coatings) or with a thick acrylic covering which has passed preliminary bonding tests. **Refer to Preliminary Identification and Bonding Tests section of this products data sheet.**

- Sound concrete.
- Brick and block masonry.
- Sound and well bonded Sandstone or Terracotta tiles.
- Always carry out preliminary checks of the substrate and prepare thoroughly in accordance with the technical specification information.

**NEW**

# PAREX BRICK SLIP SYSTEM NOW AVAILABLE

QUICK TO APPLY, SIMPLE INSTALLTION PROCESS - TRAINING PROVIDED -  
CONTACT PAREX FOR MORE DETAILS



**If you would like a project specification please contact Parex and we will email this to you.**

**Parex Ltd**

Holly Lane Industrial Estate, Atherstone, Warwickshire CV9 2QZ

**Tel: +44 (0)1827 711755 Fax: +44 (0)1827 711330**

**Email: [info@parex.co.uk](mailto:info@parex.co.uk)  
Website: [www.parex.co.uk](http://www.parex.co.uk)**



**[www.parex.co.uk](http://www.parex.co.uk)**